

BATCH DELIVERY

## RUN ID 001

3 Orders · Generated 2026-05-24

CONTRACTOR  
Gomez Installation

DELIVERY DATE  
2026-05-24

### DELIVERY ROUTE

1

**Bryan Johnson**

1450 Oak Ridge Dr, Greenville NC · 20'W x 20'L x 8'H

PO 2026-001

2

**Joe Davis**

892 County Rd 17, Wilson NC · 30'W x 50'L x 12'H

PO 2026-002

3

**David Wilson**

3221 Industrial Way, Goldsboro NC · 40'W x 40'L x 15'H

PO 2026-003

3

ORDERS

311

PANELS

51

FRAME ITEMS

11,469

SCREWS

**Disclaimer:** This cut list is generated by MetalCut Pro. All measurements and quantities must be verified against your company's standards before production.

## PANELS — CUT LIST

CUSTOMER

David Wilson

SEQ

3

SIZE

40'W x 40'L x 15'H

PANEL GA.

29 Ga

SEQ  
**03**

**132**

TOTAL PANELS

**80**

BLACK PIECES

**52**

WHITE PIECES

**10**

UNIQUE CUT LENGTHS

SEQ	QTY	DESCRIPTION	CUT LENGTH	COLOR	GAUGE
1	28	Main Roof	21 ft 5 in	Black	29 Gauge
2	28	Main Side Wall	12 ft 2 in	White	29 Gauge
3	2	Main End Wall	12 ft 10 in	White	29 Gauge
4	2	Main End Wall	13 ft 7 in	White	29 Gauge
5	4	Main End Wall	14 ft 4 in	White	29 Gauge
6	4	Main End Wall	15 ft 1 in	White	29 Gauge
7	4	Main End Wall	15 ft 10 in	White	29 Gauge
8	4	Main End Wall	16 ft 7 in	White	29 Gauge
9	4	Main End Wall	17 ft 4 in	White	29 Gauge
10	52	Wainscot	3 ft 4 in	Black	29 Gauge

**Disclaimer:** This cut list is generated by MetalCut Pro. All measurements and quantities must be verified against your company's standards before production.

# METALCUT PRO

CUT LIST SOFTWARE

RUN ID 001

PANELS

CUSTOMER

Joe Davis

SEQ

2

SIZE

30'W x 50'L x 12'H

PANEL GA.

26 Ga

SEQ  
02

166

TOTAL PANELS

98

WHITE PIECES

68

BLACK PIECES

8

UNIQUE CUT LENGTHS

SEQ	QTY	DESCRIPTION	CUT LENGTH	COLOR	GAUGE
1	34	Main Roof	16 ft 3 in	Black	26 Gauge
2	34	Lean-To Roof	12 ft 11 in	Black	26 Gauge
3	4	Main Side Wall	41 ft 0 in	White	26 Gauge
4	4	Main Side Wall	27 ft 4 in	White	26 Gauge
5	4	Main Side Wall	23 ft 5 in	White	26 Gauge
6	2	Main End Wall	30 ft 0 in	White	26 Gauge
7	16	Main End Wall	27 ft 4 in	White	26 Gauge
8	34	LT Step Down Side	9 ft 4 in	White	26 Gauge
9	34	Step-Down	1 ft 0 in	White	26 Gauge

CUSTOMER

Bryan Johnson

SEQ

1

SIZE

20'W x 20'L x 8'H

PANEL GA.

29 Ga

SEQ  
01

13

TOTAL PANELS

9

BARN RED PIECES

4

WHITE PIECES

2

UNIQUE CUT LENGTHS

SEQ	QTY	DESCRIPTION	CUT LENGTH	COLOR	GAUGE
1	9	Main Roof	21 ft 0 in	Barn Red	29 Gauge
2	2	Main End Wall	20 ft 0 in	White	29 Gauge
3	2	Main Extra Side Panel	20 ft 0 in	White	29 Gauge

**Disclaimer:** This cut list is generated by MetalCut Pro. All measurements and quantities must be verified against your company's standards before production.

## FRAME — MATERIALS

CUSTOMER Bryan Johnson	SEQ 1	SIZE 20'W x 20'L x 8'H	CERTIFIED 35/140MPH	PITCH Standard	O.C. 5 Ft	FRAME GA. 14 Ga	PANEL GA. 29 Ga
---------------------------	----------	---------------------------	------------------------	-------------------	--------------	--------------------	--------------------

QTY	DESCRIPTION	LENGTH	GAUGE
5	Bow Standard Pitch — Regular Single Leg	20 ft 0 in	14 Gauge
2	Base Rail — Single - 5' OC	20 ft 0 in	14 Gauge
10	Main Leg — Single Leg	8 ft 0 in	14 Gauge
1	Gable Framing — Gable End Upright	6 ft 0 in	14 Gauge
1	Gable Framing — Gable End Upright	6 ft 0 in	14 Gauge
2	Gable Framing — Gable End Tube Header / Upright	20 ft 0 in	14 Gauge

CUSTOMER Joe Davis	SEQ 2	SIZE 30'W x 50'L x 12'H	CERTIFIED 35/140MPH	PITCH 3:12	O.C. 4 Ft	FRAME GA. 14 Ga	PANEL GA. 26 Ga
-----------------------	----------	----------------------------	------------------------	---------------	--------------	--------------------	--------------------

QTY	DESCRIPTION	LENGTH	GAUGE
14	Lean-To Rafter — Lean-To Left	12 ft 0 in	14 Gauge
14	Lean-To Rafter — Lean-To Right	12 ft 0 in	14 Gauge
14	Truss 3:12 Pitch — Triple Wide Single Leg	30 ft 0 in	14 Gauge
1	Base Rail — Step Down - Standard — Lean-To Left	50 ft 0 in	14 Gauge
1	Base Rail — Step Down - Standard — Lean-To Right	50 ft 0 in	14 Gauge
2	Base Rail — Single - 4' OC	50 ft 0 in	14 Gauge
14	Lean-To Leg — Standard Leg — Lean-To Left	9 ft 0 in	14 Gauge
14	Lean-To Leg — Standard Leg — Lean-To Right	9 ft 0 in	14 Gauge
28	Main Leg — Single Leg	12 ft 0 in	14 Gauge
5	Hat Channel — HC-R1 — Lean-To Left	26 ft 0 in	18 Gauge
5	Hat Channel — HC-R2 — Lean-To Left	31 ft 0 in	18 Gauge
5	Hat Channel — HC-R1 — Lean-To Right	26 ft 0 in	18 Gauge
5	Hat Channel — HC-R2 — Lean-To Right	31 ft 0 in	18 Gauge
12	Hat Channel — HC-R1	26 ft 0 in	18 Gauge

**Disclaimer:** This cut list is generated by MetalCut Pro. All measurements and quantities must be verified against your company's standards before production.

QTY	DESCRIPTION	LENGTH	GAUGE
12	Hat Channel — HC-R2	31 ft 0 in	18 Gauge
2	Uprights — Single Tubing — Lean-To Left	10 ft 0 in	14 Gauge
2	Uprights — Single Tubing — Lean-To Left	11 ft 0 in	14 Gauge
2	Tubing — End Wall Base B2 — Lean-To Left	12 ft 0 in	14 Gauge
2	Uprights — Single Tubing — Lean-To Right	10 ft 0 in	14 Gauge
2	Uprights — Single Tubing — Lean-To Right	11 ft 0 in	14 Gauge
2	Tubing — End Wall Base B2 — Lean-To Right	12 ft 0 in	14 Gauge
11	Uprights — End Wall Single Tubing	14 ft 0 in	14 Gauge
2	Tubing — End Wall Base B1	30 ft 0 in	14 Gauge
1	End Wall Upright — Splice Support (Front Continuous EW)	14 ft 0 in	14 Gauge
1	End Wall Upright — Splice Support (Back Continuous EW)	14 ft 0 in	14 Gauge
2	Tubing — Walk-In Door Frame	20 ft 0 in	14 Gauge
1	Tubing — Window Frame	15 ft 0 in	14 Gauge
1	Tubing — Window Frame	15 ft 0 in	14 Gauge
4	Header Support — Above Roll-Up Door (10x10)	4 ft 0 in	14 Gauge

CUSTOMER David Wilson	SEQ 3	SIZE 40'W x 40'L x 15'H	CERTIFIED 35/140MPH	PITCH 3:12	O.C. 4 Ft	FRAME GA. 14 Ga	PANEL GA. 29 Ga
--------------------------	----------	----------------------------	------------------------	---------------	--------------	--------------------	--------------------

QTY	DESCRIPTION	LENGTH	GAUGE
11	Truss 3:12 Pitch — Commercial Ladder Gable Truss	40 ft 0 in	14 Gauge
4	Base Rail — Ladder - 4' OC	40 ft 0 in	14 Gauge
22	Main Leg — Ladder Style	15 ft 0 in	14 Gauge
28	Hat Channel — HC-R1	21 ft 0 in	18 Gauge
16	Uprights — End Wall Single Tubing	16 ft 0 in	14 Gauge
4	Tubing — End Wall Base B1	20 ft 0 in	14 Gauge
2	Tubing — Walk-In Door Frame	20 ft 0 in	14 Gauge
1	Tubing — Window Frame	15 ft 0 in	14 Gauge
1	Tubing — Window Frame	15 ft 0 in	14 Gauge
1	Tubing — Window Frame	15 ft 0 in	14 Gauge

**Disclaimer:** This cut list is generated by MetalCut Pro. All measurements and quantities must be verified against your company's standards before production.

QTY	DESCRIPTION	LENGTH	GAUGE
1	Tubing — Window Frame	15 ft 0 in	14 Gauge
1	Tubing — Window Frame	15 ft 0 in	14 Gauge
1	Tubing — Window Frame	15 ft 0 in	14 Gauge
4	Header Support — Above Roll-Up Door (12x12)	4 ft 0 in	14 Gauge
28	Horizontal-Framing — Tubing (2.5")	20 ft 0 in	18 Gauge
4	Hat Channel Brace — Longitudinal Brace	21 ft 0 in	18 Gauge

**Disclaimer:** This cut list is generated by MetalCut Pro. All measurements and quantities must be verified against your company's standards before production.

## DOORS & WINDOWS

CUSTOMER Bryan Johnson	SEQ 1	SIZE 20'W x 20'L x 8'H	CERTIFIED 35/140MPH	PITCH Standard	O.C. 5 Ft	FRAME GA. 14 Ga	PANEL GA. 29 Ga
---------------------------	----------	---------------------------	------------------------	-------------------	--------------	--------------------	--------------------

No doors/windows.

CUSTOMER Joe Davis	SEQ 2	SIZE 30'W x 50'L x 12'H	CERTIFIED 35/140MPH	PITCH 3:12	O.C. 4 Ft	FRAME GA. 14 Ga	PANEL GA. 26 Ga
-----------------------	----------	----------------------------	------------------------	---------------	--------------	--------------------	--------------------

QTY	DESCRIPTION	LOCATION	FACING
2	G.Door Certified -10x10 White/ 2 hardware/ 2 Pairs of Tracks/ 2 Chain opener	Main Unit	Front
1	G.Door Uncertified -9x8 White/ 1 hardware/ 1 Pairs of Tracks/ 1 Electric opener	LT Left	Front
1	G.Door Uncertified -9x8 White/ 1 hardware/ 1 Pairs of Tracks/ 1 Electric opener	LT Right	Front
2	Window -36x36 White	Main Unit	Back
1	Walk-In Door Six Paneled -36x80 White/ 1 Knob	Main Unit	Back
1	Walk-In Door Six Paneled -36x80 White/ 1 Knob	LT Left	Lower Side

CUSTOMER David Wilson	SEQ 3	SIZE 40'W x 40'L x 15'H	CERTIFIED 35/140MPH	PITCH 3:12	O.C. 4 Ft	FRAME GA. 14 Ga	PANEL GA. 29 Ga
--------------------------	----------	----------------------------	------------------------	---------------	--------------	--------------------	--------------------

QTY	DESCRIPTION	LOCATION	FACING
2	G.Door Certified -12x12 Black/ 2 hardware/ 2 Pairs of Tracks/ 2 Chain opener	Main Unit	Front
3	Window -30x36 Black	Main Unit	Left Side
3	Window -30x36 Black	Main Unit	Right Side
1	Walk-In Door Six Paneled -36x80 Black/ 1 Knob	Main Unit	Front
1	Walk-In Door Six Paneled -36x80 Black/ 1 Knob	Main Unit	Right Side

**Disclaimer:** This cut list is generated by MetalCut Pro. All measurements and quantities must be verified against your company's standards before production.

## HARDWARE & SCREWS

CUSTOMER Bryan Johnson	SEQ 1	SIZE 20'W x 20'L x 8'H	CERTIFIED 35/140MPH	PITCH Standard	O.C. 5 Ft	FRAME GA. 14 Ga	PANEL GA. 29 Ga
---------------------------	----------	---------------------------	------------------------	-------------------	--------------	--------------------	--------------------

QTY	DESCRIPTION	NOTES
4	MHA - Mobile Home Anchors (Ground)	Max 25' spacing
10	Rebar Anchors	
4	MHA Bolt Set 6" (Bolt, Nut, 2 Washers)	Single leg
6	Corner Braces (3 ft)	U-Channel, Height: 8'
3	Top Braces (4 ft)	Span: 20'
320	Frame Screws - Main Unit	
320	TOTAL FRAME SCREWS	
20	L-Brackets	Screws: 80
10	Nipples 7" (Bow Connection)	2 per bow · Screws: 40 (incl. in Frame Screws)
199	Roof Screws - Main Roof	Galvanized — Panels: 9
64	Side Panels Screws - Main Unit	Galvanized — Horizontal
140	Gable End Panel Screws - Main Unit	Galvanized — Horizontal
199	TOTAL ROOF SCREWS	
204	TOTAL WALL SCREWS	

**Disclaimer:** This cut list is generated by MetalCut Pro. All measurements and quantities must be verified against your company's standards before production.

# METALCUT PRO

CUT LIST SOFTWARE

RUN ID

001

HARDWARE

CUSTOMER

Joe Davis

SEQ

2

SIZE

30'W x 50'L x 12'H

CERTIFIED

35/140MPH

PITCH

3:12

O.C.

4 Ft

FRAME GA.

14 Ga

PANEL GA.

26 Ga

QTY	DESCRIPTION	NOTES
88	Concrete Anchors	Legs: 28, Uprights: 14, Corners: 4, LT Legs: 26, LT Uprights: 8, LT Corners: 8
24	Corner Braces (4 ft)	U-Channel, Height: 12'
11	Corner Braces LT (4 ft)	Lean-To L
11	Corner Braces LT (4 ft)	Lean-To R
1184	Frame Screws - Main Unit	
796	Frame Screws - Lean-To	
1980	TOTAL FRAME SCREWS	
122	L-Brackets	Screws: 488
4	Sleeves 1 ft - Base Rail Connection	Sidewalls - 1 connection(s), LT L - 1, LT R - 1, Screws: 32
976	Roof Screws - Main Roof	Black — Panels: 34
836	Panel Screws - Lean-To Roof (Black)	Black — All Lean-Tos
512	Side Panels Screws - Main Unit	White — Horizontal
450	End Wall Panel Screws - Main Unit	White — Horizontal
578	Side Panels Screws - Lean-To	White — All Lean-Tos
368	End Wall Panel Screws - Lean-To	White — All Lean-Tos
314	Panel Screws - Step Down (White)	White — Upper wall LT
1812	TOTAL ROOF SCREWS	
2222	TOTAL WALL SCREWS	

**Disclaimer:** This cut list is generated by MetalCut Pro. All measurements and quantities must be verified against your company's standards before production.

# METALCUT PRO

CUT LIST SOFTWARE

RUN ID

001

HARDWARE

CUSTOMER

David Wilson

SEQ

3

SIZE

40'W x 40'L x 15'H

CERTIFIED

35/140MPH

PITCH

3:12

O.C.

4 Ft

FRAME GA.

14 Ga

PANEL GA.

29 Ga

QTY	DESCRIPTION	NOTES
66	Concrete Anchors	Legs: 44, Uprights: 18, Corners: 4
18	Corner Braces (4 ft)	U-Channel, Height: 15'
2448	Frame Screws - Main Unit	
2448	TOTAL FRAME SCREWS	
340	L-Brackets	Screws: 1360
2	Sleeves 1 ft - Base Rail Connection	Sidewalls - 1 connection(s), Screws: 16
2	Sleeves 1 ft - End Wall Base Connection	End Wall Base Tubing, Screws: 16
924	Roof Screws - Main Roof	Black — Panels: 28
443	Side Panels Screws - Main Unit	White — Vertical
383	End Wall Panel Screws - Main Unit	White — Vertical
534	Panel Screws - Main Wainscot (Black)	Black — Wainscot 3'
924	TOTAL ROOF SCREWS	
826	TOTAL WALL SCREWS	
534	TOTAL WAINSCOT SCREWS	

**Disclaimer:** This cut list is generated by MetalCut Pro. All measurements and quantities must be verified against your company's standards before production.

## DIAGRAMS

CUSTOMER

Bryan Johnson

SEQ

1

SIZE

20'W x 20'L x 8'H

CERTIFIED

35/140MPH

PITCH

Standard

O.C.

5 Ft

FRAME GA.

14 Ga

PANEL GA.

29 Ga

### Building Overview

#### Building Footprint - Top View

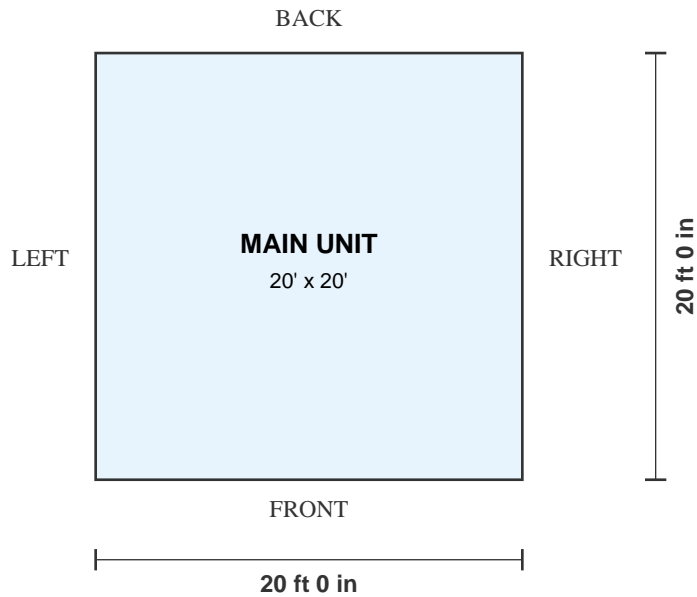

**Disclaimer:** This cut list is generated by MetalCut Pro. All measurements and quantities must be verified against your company's standards before production.

## Main Left Side

ORDER 1 · Bryan Johnson · 20'W x 20'L x 8'H

### Main Left Side

20 ft 0 in Length x 8 ft 0 in tall

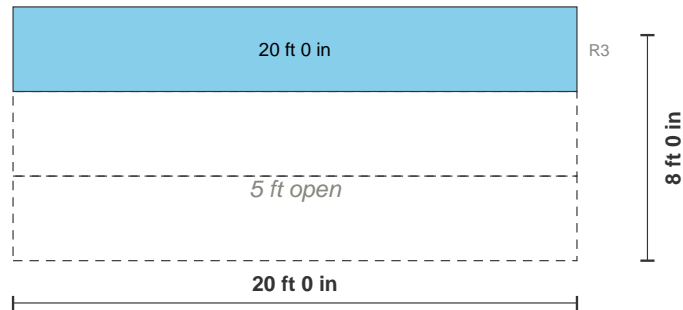

## Main Right Side

### Main Right Side

20 ft 0 in Length x 8 ft 0 in tall

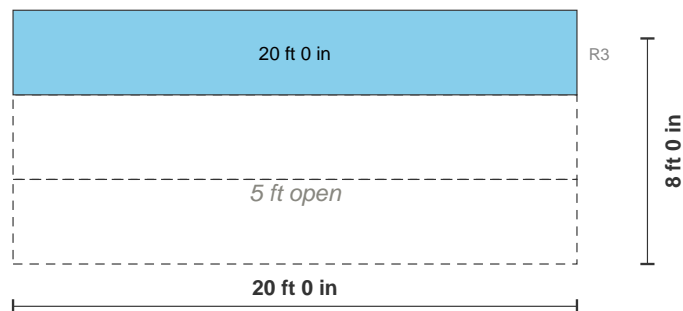

**Disclaimer:** This cut list is generated by MetalCut Pro. All measurements and quantities must be verified against your company's standards before production.

## Main End Front

ORDER 1 · Bryan Johnson · 20'W x 20'L x 8'H

### Main End Front

20 ft 0 in wide x 8 ft 0 in tall

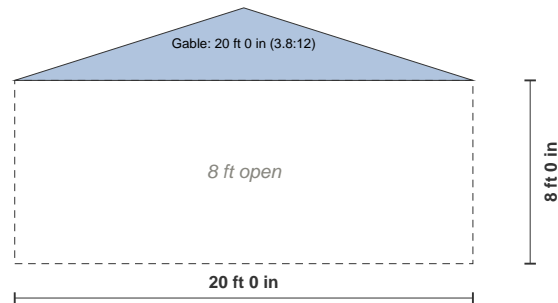

#### Panel Cuts:

1x 20 ft 0 in Gable End

## Main End Back

### Main End Back

20 ft 0 in wide x 8 ft 0 in tall

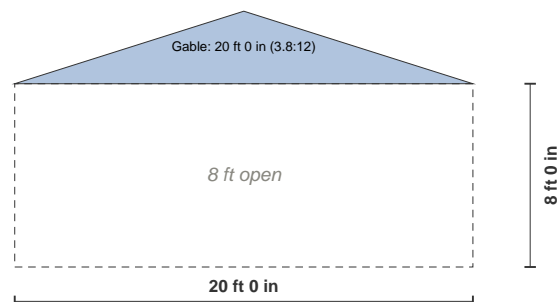

#### Panel Cuts:

1x 20 ft 0 in Gable End

CUSTOMER	SEQ	SIZE	CERTIFIED	PITCH	O.C.	FRAME GA.	PANEL GA.
Joe Davis	2	30'W x 50'L x 12'H	35/140MPH	3:12	4 Ft	14 Ga	26 Ga

## Building Overview

### Building Footprint - Top View

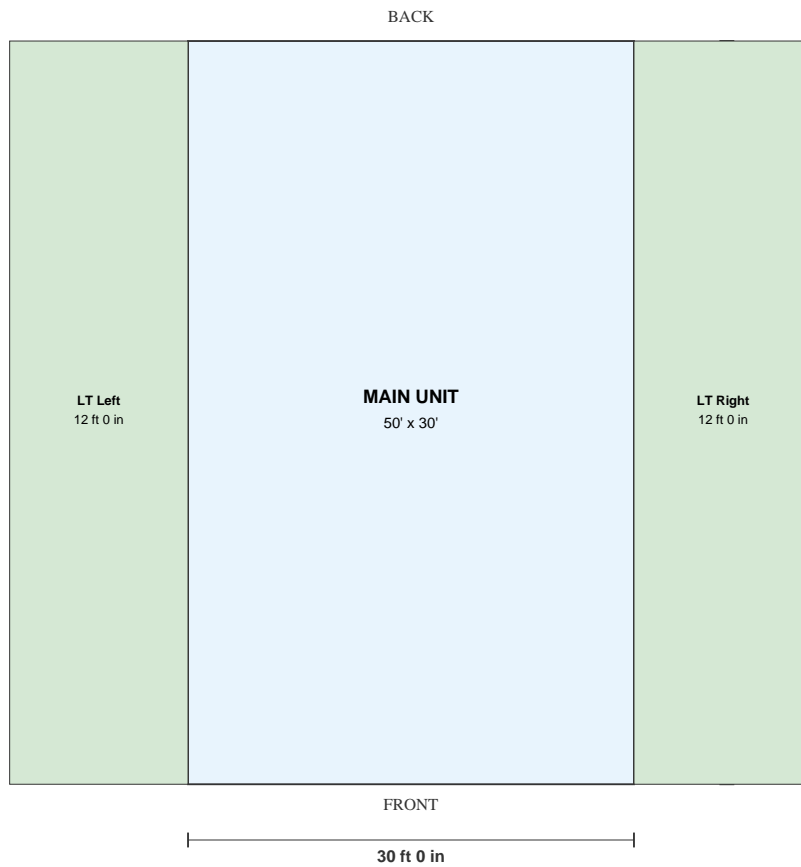

**Disclaimer:** This cut list is generated by MetalCut Pro. All measurements and quantities must be verified against your company's standards before production.

## Main Left Side

ORDER 2 · Joe Davis · 30"W x 50'L x 12'H

### Main Left Side

50 ft 0 in Length x 12 ft 0 in tall

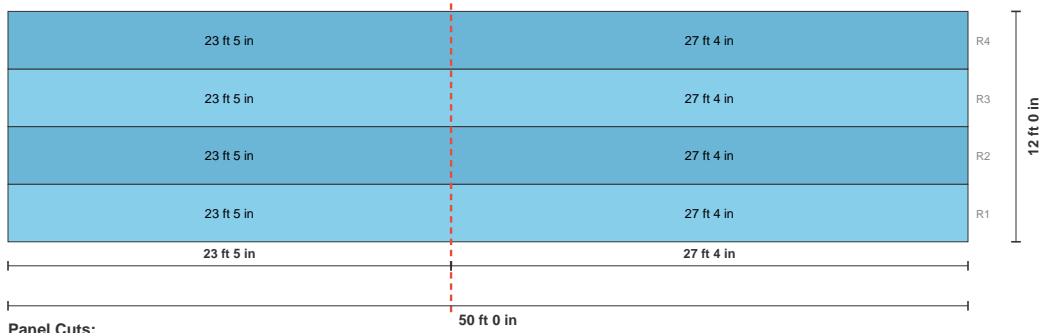

#### Panel Cuts:

- 2x 41 ft 0 in
- 2x 27 ft 4 in
- 2x 23 ft 5 in

## Main Right Side

### Main Right Side

50 ft 0 in Length x 12 ft 0 in tall

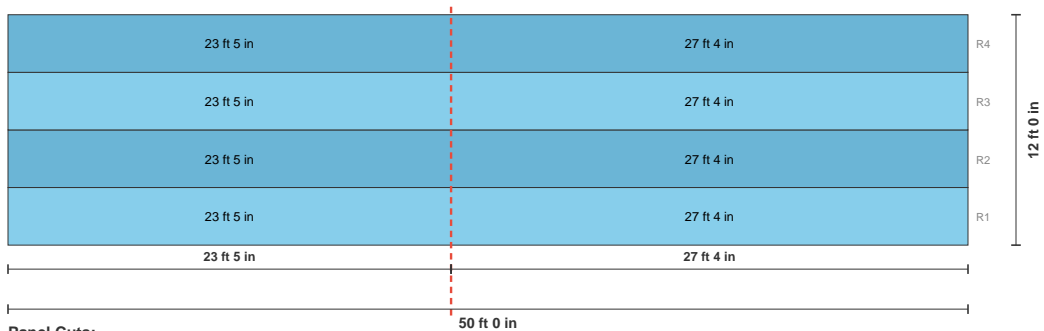

#### Panel Cuts:

- 2x 41 ft 0 in
- 2x 27 ft 4 in
- 2x 23 ft 5 in

**Disclaimer:** This cut list is generated by MetalCut Pro. All measurements and quantities must be verified against your company's standards before production.

## LT Left Side

ORDER 2 · Joe Davis · 30'W x 50'L x 12'H

### LT Left Side

50 ft 0 in long x 9 ft 0 in tall

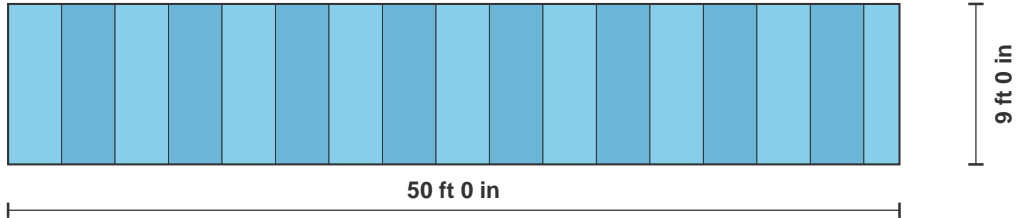

**CUT LIST:**

p01 thru p17 - 9 ft 4 in (17 panels)

## LT Right Side

### LT Right Side

50 ft 0 in long x 9 ft 0 in tall

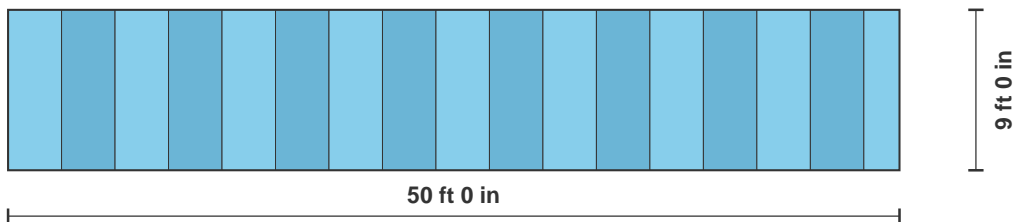

**CUT LIST:**

p01 thru p17 - 9 ft 4 in (17 panels)

## Combined End Front

ORDER 2 · Joe Davis · 30'W x 50'L x 12'H

### Combined End Front

Combined View: 54 ft 0 in total width

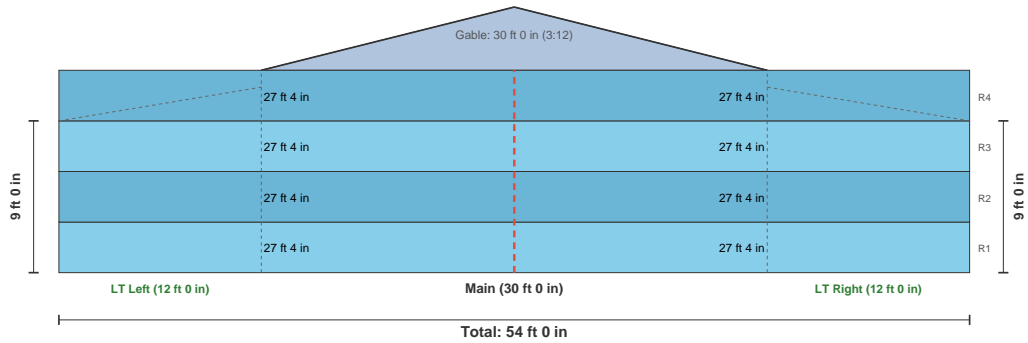

## Combined End Back

### Combined End Back

Combined View: 54 ft 0 in total width

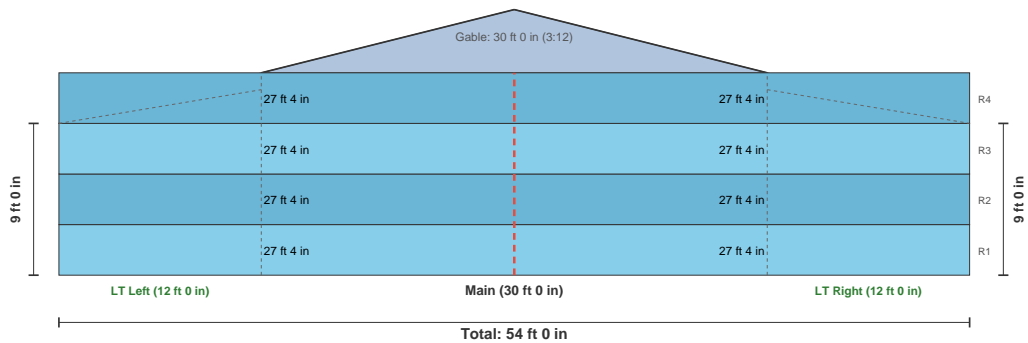

**Disclaimer:** This cut list is generated by MetalCut Pro. All measurements and quantities must be verified against your company's standards before production.

CUSTOMER	SEQ	SIZE	CERTIFIED	PITCH	O.C.	FRAME GA.	PANEL GA.
David Wilson	3	40'W x 40'L x 15'H	35/140MPH	3:12	4 Ft	14 Ga	29 Ga

## Building Overview

### Building Footprint - Top View

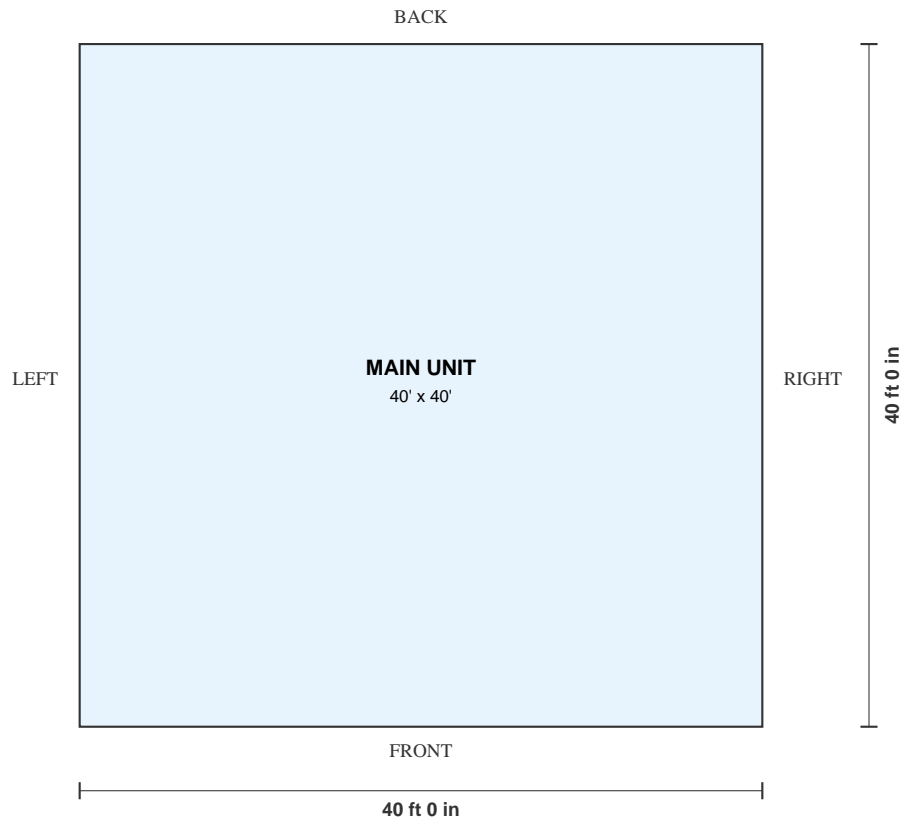

**Disclaimer:** This cut list is generated by MetalCut Pro. All measurements and quantities must be verified against your company's standards before production.

## Main Left Side

ORDER 3 · David Wilson · 40'W x 40'L x 15'H

### Main Left Side

40 ft 0 in long x 12 ft 0 in tall

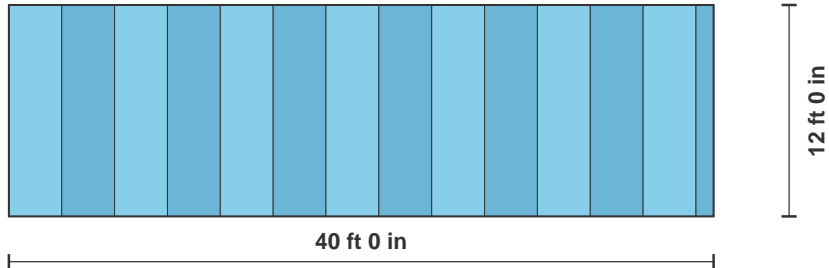

#### CUT LIST:

L01 thru L14 - 12 ft 4 in (14 panels)

Wainscot - 14 pcs 3 ft 4 in

## Main Right Side

### Main Right Side

40 ft 0 in long x 12 ft 0 in tall

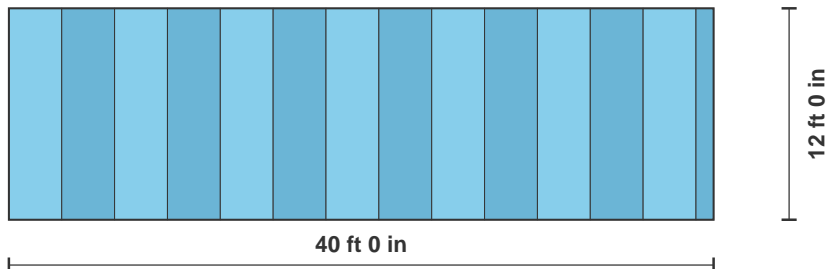

#### CUT LIST:

R01 thru R14 - 12 ft 4 in (14 panels)

Wainscot - 14 pcs 3 ft 4 in

## Main End Front

ORDER 3 · David Wilson · 40'W x 40'L x 15'H

### Main End Front

40 ft 0 in wide x 12 ft 0 in tall (3:12)

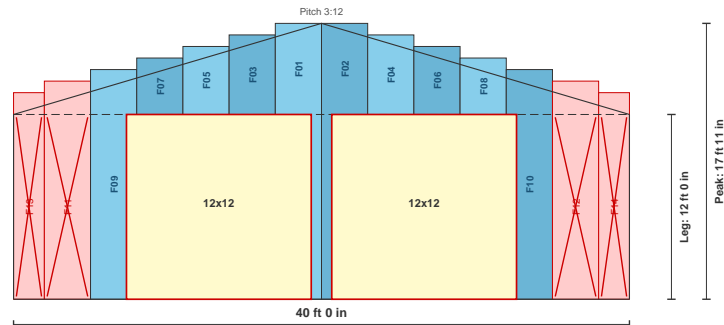

#### CUT LIST:

F01 - 17 ft 11 in	F02 - 17 ft 11 in
F03 - 17 ft 2 in	F04 - 17 ft 2 in
F05 - 16 ft 5 in	F06 - 16 ft 5 in
F07 - 15 ft 8 in	F08 - 15 ft 8 in
F09 - 14 ft 11 in	F10 - 14 ft 11 in
F11 - X REMOVED (door ded.)	F12 - X REMOVED (door ded.)
F13 - X REMOVED (door ded.)	F14 - X REMOVED (door ded.)

See invoice for garage door distribution details.  
Wainscot - 14 pcs 3 ft 4 in

## Main End Back

### Main End Back

40 ft 0 in wide x 12 ft 0 in tall (3:12)

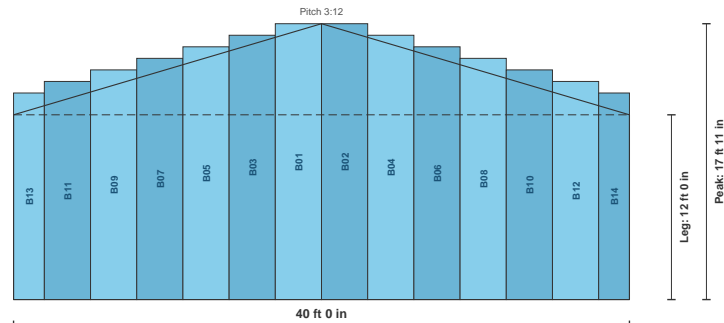

#### CUT LIST:

B01 - 17 ft 11 in	B02 - 17 ft 11 in
B03 - 17 ft 2 in	B04 - 17 ft 2 in
B05 - 16 ft 5 in	B06 - 16 ft 5 in
B07 - 15 ft 8 in	B08 - 15 ft 8 in
B09 - 14 ft 11 in	B10 - 14 ft 11 in
B11 - 14 ft 2 in	B12 - 14 ft 2 in
B13 - 13 ft 5 in	B14 - 13 ft 5 in

Wainscot - 14 pcs 3 ft 4 in

**Disclaimer:** This cut list is generated by MetalCut Pro. All measurements and quantities must be verified against your company's standards before production.